

Scotland Island energy reliability project

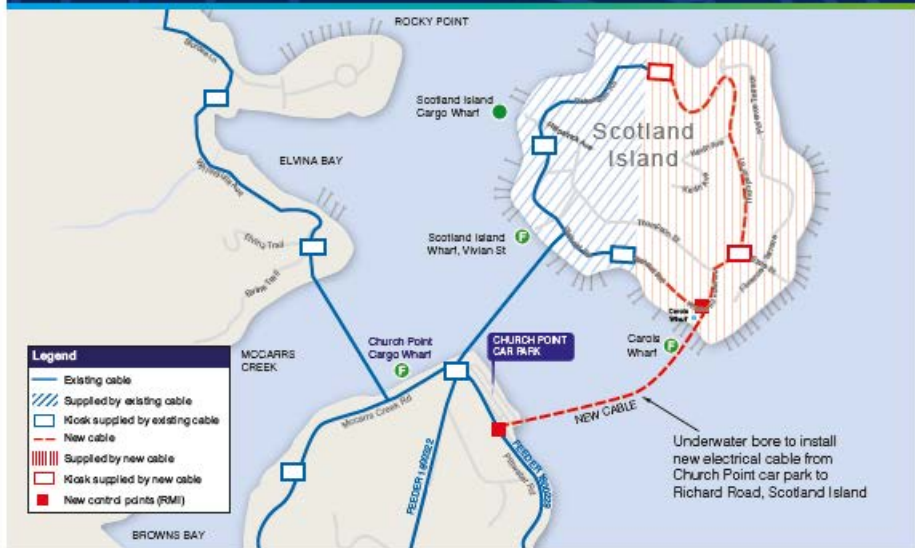

Project update

The backup electricity cable to Scotland Island is in the final stages of design with construction planned to start in early August. Ausgrid have appointed Dunstons as the contractor to carry out this work.

The new cable will be housed in a conduit (plastic pipe) installed using a horizontal directional drill (HDD) to bore under the waterway between Church Point Reserve Carpark and Richard Road on Scotland Island.

Two additional conduits will also be installed for future cables and space will be provided for fibre which may be used for the NBN rollout to the Island. A switching system will also be installed so we can isolate faults in the overhead network, as required. This will mean we can restrict power outages to a smaller number of residents whilst the problem is being resolved.

Project timing

Work will start onsite in early August and is expected to take four or five months. All work is expected to be complete before Christmas 2019, weather and ground conditions permitting.

An assessment will be done in late October to determine progress and whether work is on track to be completed before the Christmas and New Year school holiday period. If not, the site will be reduced and fenced off and the carpark reopened for the holidays with the final work to be carried out from February 2020. We will keep you updated about this as we progress.

Community information sessions

We are holding two information sessions to give you an opportunity to find out more about the project, meet the project team and discuss any issues or concerns you may have. There is no formal presentation, so you can drop in any time.

Location: The Waterfront Café, 1860 Pittwater Road, Church Point

Session 1: Thursday 25 July | 5:30pm - 7:30pm

Session 2: Saturday 27 July | 10am - 12pm

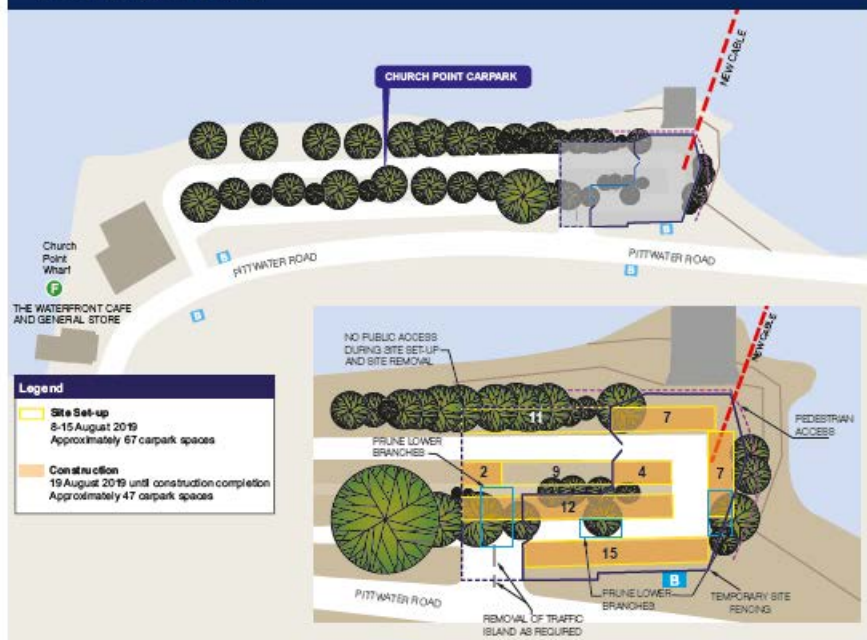

Impacts to Church Point Reserve Carpark and alternate parking arrangements

Dunstons will be occupying a section at the southern end of the Church Point Reserve Carpark for the duration of construction. This will impact between 47 and 67 parking spaces at various times (see diagram above).

We recognise that a lot of people use the carpark and our work will be disruptive and inconvenient. To minimise impacts, we are working closely with Northern Beaches Council to develop a plan to relocate up to 70 carpark spaces from Church Point to Rowland Reserve for the duration of the work.

We will be providing a substantial dollar-rebate incentive for those that take up this offer and are looking at funding some alternate transport to and from Rowland Reserve.

We are asking for all the parking spaces indicated on the map to be cleared from midnight on 4 August. Signs will also be in place in the carpark to remind carpark users.

From 5 August we will be trimming a number of low hanging branches in the carpark and will start to set-up the site from 8 August. From approximately 15 August, once all of the equipment is in and the work site is established and safe, we will re-open approximately 20 parking spaces as indicated on the map. Please note that these dates may be subject to change due to unforeseen

circumstances. We will keep the community updated if there are any changes.

The parking meter located in the middle nature strip is being temporarily relocated 50 meters north to make sure it can be safely accessed by carpark users while the work is happening.

Relocating to Rowland Reserve and alternative commuting options

We are asking up to 70 Scotland Island and West Pittwater residents with Church Point parking permits to volunteer to move their cars to during the work. We are offering a \$350 discount on their annual parking permit to park at Rowland Reserve as an alternative to Church Point for the duration of the work.

We are finalising logistics with Council on how to best facilitate a permit swap and will have more information in the coming weeks on how to register your interest.

In order to identify the most suitable transport option between Rowland Reserve and Church Point Reserve Car park, we will need to understand when cars are accessed by permit holders to support those who take up the offer.

Please visit the link at www.surveymonkey.com/r/sctIndnd to complete a questionnaire to help us understand your needs. We will share the feedback received at the community information sessions.

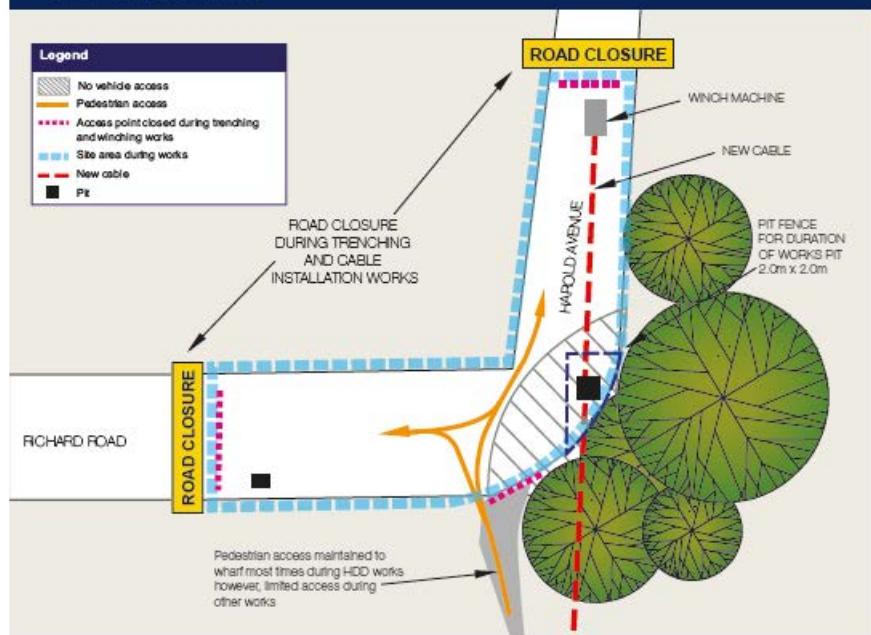

Access to Richard Road, Carols Wharf and Harold Reserve

The corner of Richard Road and Harold Avenue will be the exit point for the HDD bore. This part of the road will be closed to vehicles from early September for about three or four months.

We will maintain pedestrian access to Richard Road most of the time and to the wharf and reserve from the road.

However, there will be times when access will be restricted during work hours - we will notify the community before any changes are made. We will provide more detailed information about the closure closer to the time.

Access to the wharf from the water will be maintained at all times and ferry, water taxi and boat activities will not be affected.



What to expect during construction

The HDD bore will extend from the eastern end of Church Point Reserve Carpark to Richard Road on Scotland Island, as shown on the diagram below. The bore will start from the carpark and exit in Richard Road, next to the Carols Wharf access point.

There will be some noisy work, including saw cutting and rock breaking at the start of the work, but we will minimise this as much as we can. Once the bore starts, you may notice a humming noise.

Once the bore is complete, we will be doing some trenching work at and around the entry and exit points in the Church Point Reserve Carpark and Richard Road to connect the new cables to the existing electricity network.

To enable us to isolate faults in the overhead network during an outage, we will install two new electrical units in the garden bed in the Church Point Reserve Carpark and one in the grass verge outside 1 Richard Road. These units will be about 1.9m (L) x 1.2m (W) x 1.6m (H).

Contacting us

For more details please contact the community engagement team:

Call 1800 604 765
Email majorprojects@ausgrid.com.au
Visit ausgrid.com.au/scotlandisland



Interpreter service 131 450

Work hours

Work hours are 7 am to 6 pm Mondays to Fridays and 8 am to 1 pm on Saturdays. From time to time, we may need to work outside these hours. We will notify affected residents before any out of hours work begins. Hours may be extended as the project progresses to ensure that the HDD works are completed by the 20th of December.

Your power supply

We do not plan to interrupt your power supply to complete the construction work. We will let you know in advance if this changes.

Register for email updates

As letterbox drops can be difficult for offshore properties, we are encouraging residents and interested community members to register to receive email updates throughout construction. You can send your email and property address to majorprojects@ausgrid.com.au to register.

Updates will also be available on the website www.ausgrid.com.au/scotlandisland

Complete the questionnaire at www.surveymonkey.com/r/scctndind and then **We want your input**

